

Outline Drawing

客户确认签名
Customer approved

日期
Date



VER	REVISION RECORD	Date	Name
A	NEW RELEASE	2020/11/13	Zhou
B			
C			

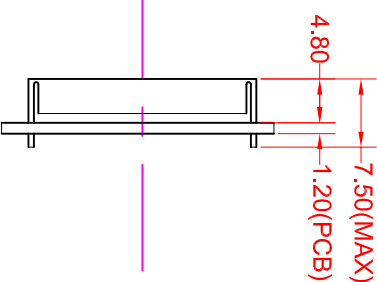
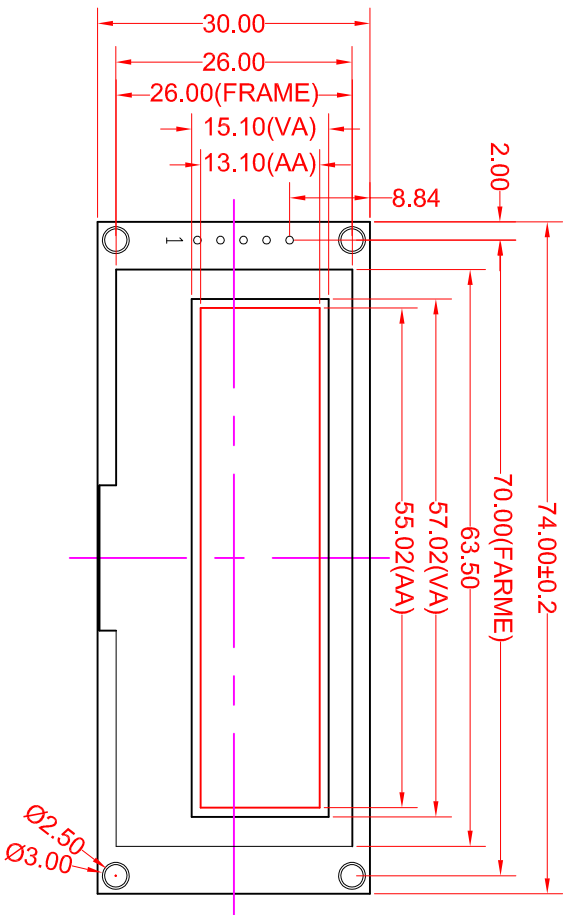

PINS DESCRIPTION (接口定义)

PIN SYMBOL	FUNCTION
1 GND	GROUND (逻辑地)
2 VCC	POWER SUPPLY PIN (逻辑电源正: 3V/5.0V)
3 SCLK	SERIAL CLOCK (串口时钟信号)
4 SDA	SERIAL DATA (串口数据信号)
5 RES	RESET (复位信号)

NOTE

1. Display Type: 2.23" PM-OLED, 128x32
2. Viewing Direction: ALL
3. Logic Supply Voltage: 3.0V(SSD1305), VCC=3.3V OR 5.0V
4. OLED Panel driving voltage: 12.0V
5. Control IC: SSD1305
6. Display color: White
7. Operating Temp: -40 TO 80
8. Storage Temp: -40 TO 85°C
9. Ulteriorly Tolerance: ±0.2MM

EVD223EM5IW01
EV---Company Code
D---OLED
223---Panel size 2.23 inch
E---Serial No. A-Z
M---Module: P--Panel
5---Interface pin
I---IIC
W---Display color: White/Yellow/Blue/Green
01---Ver. No.



深圳市隼目显示技术有限公司
Shenzhen Eagle Vision Display Technology Co., Ltd

Dwg:	CUSTOMER	LCM TYPE
Check:	MODULE	Material No.
Dim: MM	Visual Angle	SCALE: 1:1
		SHEET 1 OF 1