

# Outline Drawing

客户确认签名  
Customer approved

日期  
Date



VER	REVISION RECORD	Date	Name
A	NEW RELEASE	2018/10/22	LT
B			
C			

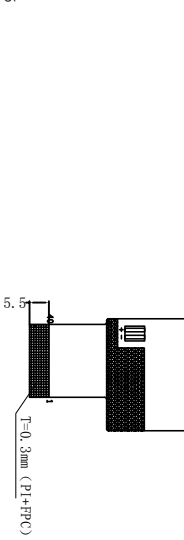
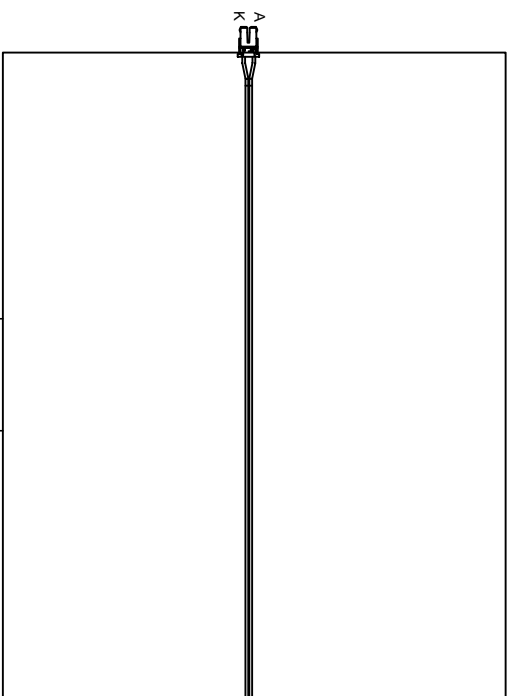
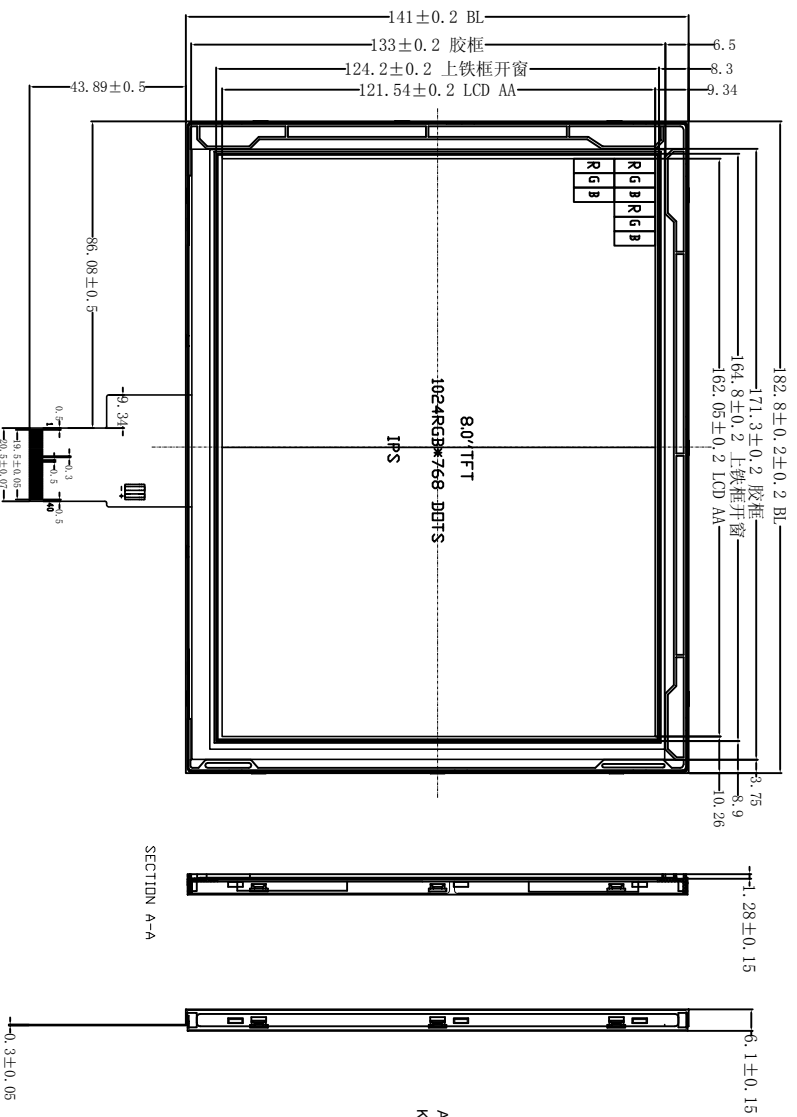

PIN	NAME
1	VCOM
2	VDD
3	VDD
4	NC
5	RESET
6	STBYB
7	GND
8	RX1N0-
9	RX1N+
10	GND
11	RX1N1-
12	RX1N1+
13	GND
14	RX1N2-
15	RX1N2+
16	GND
17	RXCLK-
18	RXCLK+
19	GND
20	RX1N3-
21	RX1N3+
22	GND
23	NC
24	NC
25	GND
26	NC
27	D1M0
28	SE1B
29	AVDD
30	GND
31	LED-
32	LED+
33	L/R
34	U/D
35	VGL
36	CARBEN1
37	CARBEN0
38	VGH
39	LED+
40	LED+

## NOTE

- 1.Lcd Display Type: 8.0" TFT, 1024\*768, IPS, LVDS
- 2.Polarizer Mode: Transmissive, normally black
- 3.Viewing Direction: ALL
- 4.Logic Supply Voltage: 3.0V
- 5.Control IC:
- 6.Backlight: White(10\*3 Led), Iled=200mA, Vled=9.3V
- 7.Backlight brightness and uniformity: 350cd/m2, >=80%
- 8.Operating Temp: -10 TO 50
- 9.Storage Temp: -20 TO 60℃
- 10.Connector: FPC
- 11.Utteriorly Tolerance: ±0.2MM

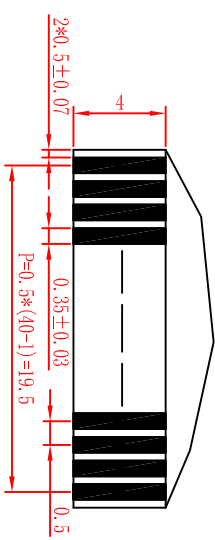

深圳市集目显示技术有限公司  
Shenzhen Eagle Vision Display Technology Co., Ltd

Dwg:	CUSTOMER	Material No.	8 1H" TFT
Check:	MODULE	SCALE: 1:1	
Drawn:	Visual Angle	SHEET 1 OF 1	